



CRS-2M Steering Tube Bearing Installer

Park Tool Co. 5115 Hadley Ave. N., St. Paul, MN 55128 (USA) www.parktool.com

Introduction:

The traditional way to "set" the bearing on the lower triple tree was to slam it on with a large pipe or slide hammer. The CRS-2M Steering Tube Bearing Installer offers a new approach that is safer and more precise. With the CRS-2M, specially-sized aluminum rings protect the bearing from a direct hit, making it safe and effective for use on almost any triple tree.

The CRS-2M Steering Tube Bearing Installer includes three specially-sized aluminum rings and one universal driver tube for installing the bearing used on most 1", 1-1/8" and 1-3/8" triple trees.

Instructions:

1. Clean the lower bearing and the lower bearing seat so they are completely free of grease or oil.
2. Place bearing on steering stem.
3. Select the appropriate aluminum ring and place it on the bearing.
4. Place driver tube (#830A) over aluminum ring and tap down with a hammer until the bearing is properly seated.

(Continued on reverse)

#830A Universal Driver Tube

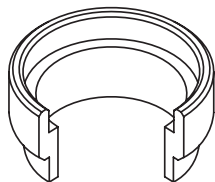

#835

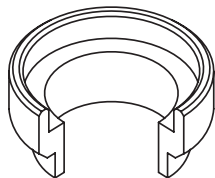

#832

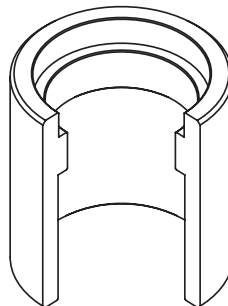

#839